

JANNAT LÜBNAN

A HEAVEN OF TRANQUILLITY







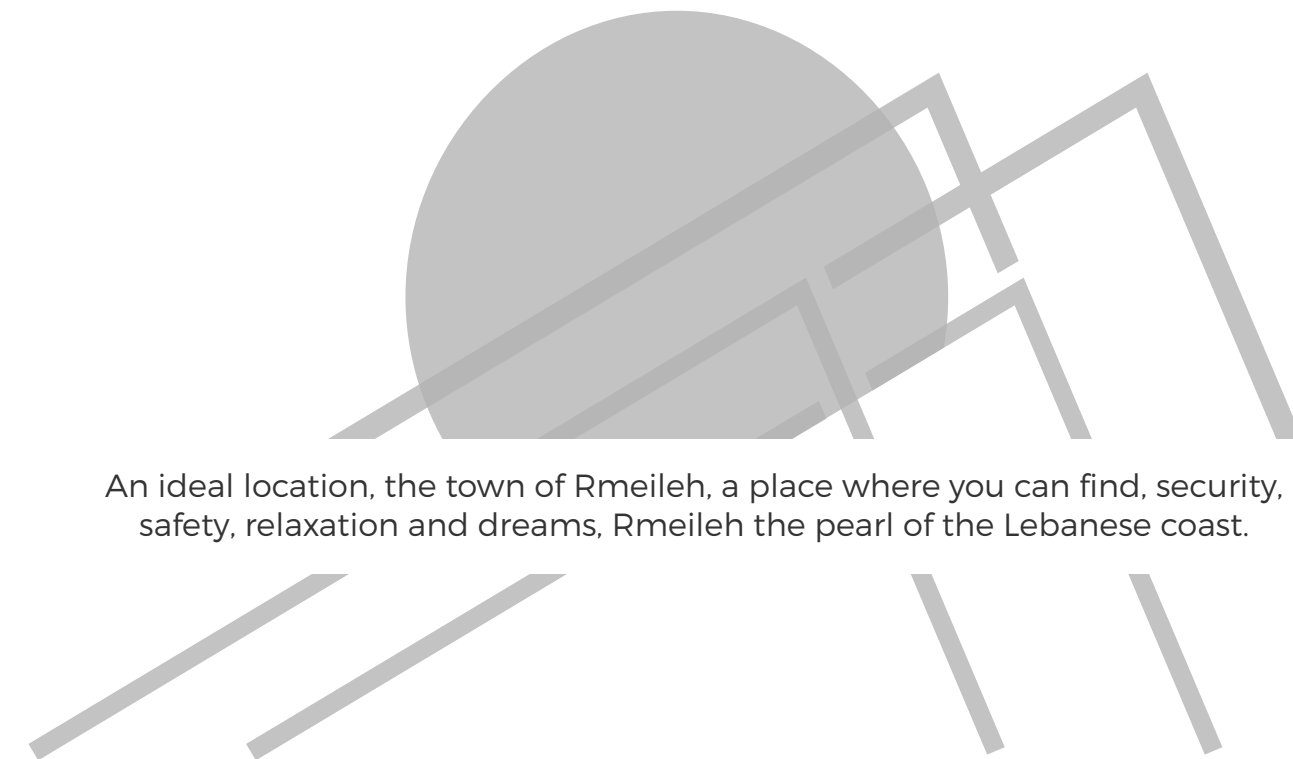

An ideal location, the town of Rmeileh, a place where you can find, security, safety, relaxation and dreams, Rmeileh the pearl of the Lebanese coast.

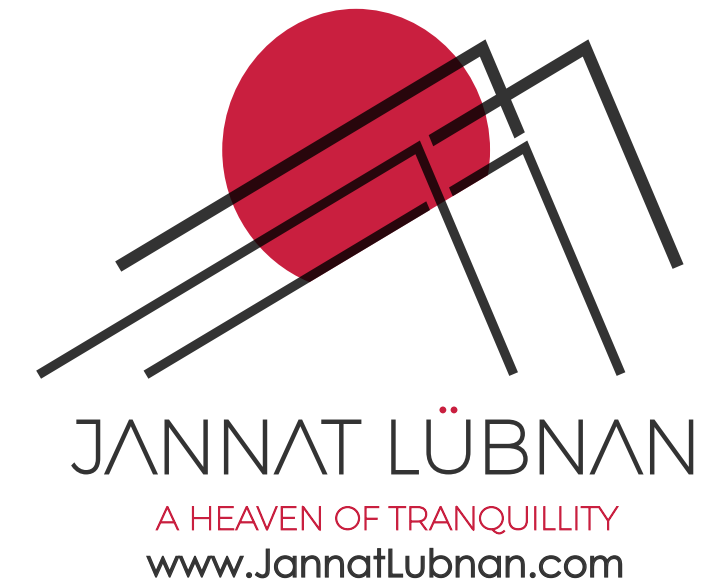



MARVELOUS VIEW  
OVERLOOKING THE SEA





# THE LOCATION //

The charming town is very well served by manyresorts, supermarkets, cafes,shops andrestaurants. Adjacent to a University, 25minute drive from downtown Beirut, 20minutes away from the airport and a 5 minute drive to nearby attractions such as the Sidon Souk and the Sidon Beach Castle.

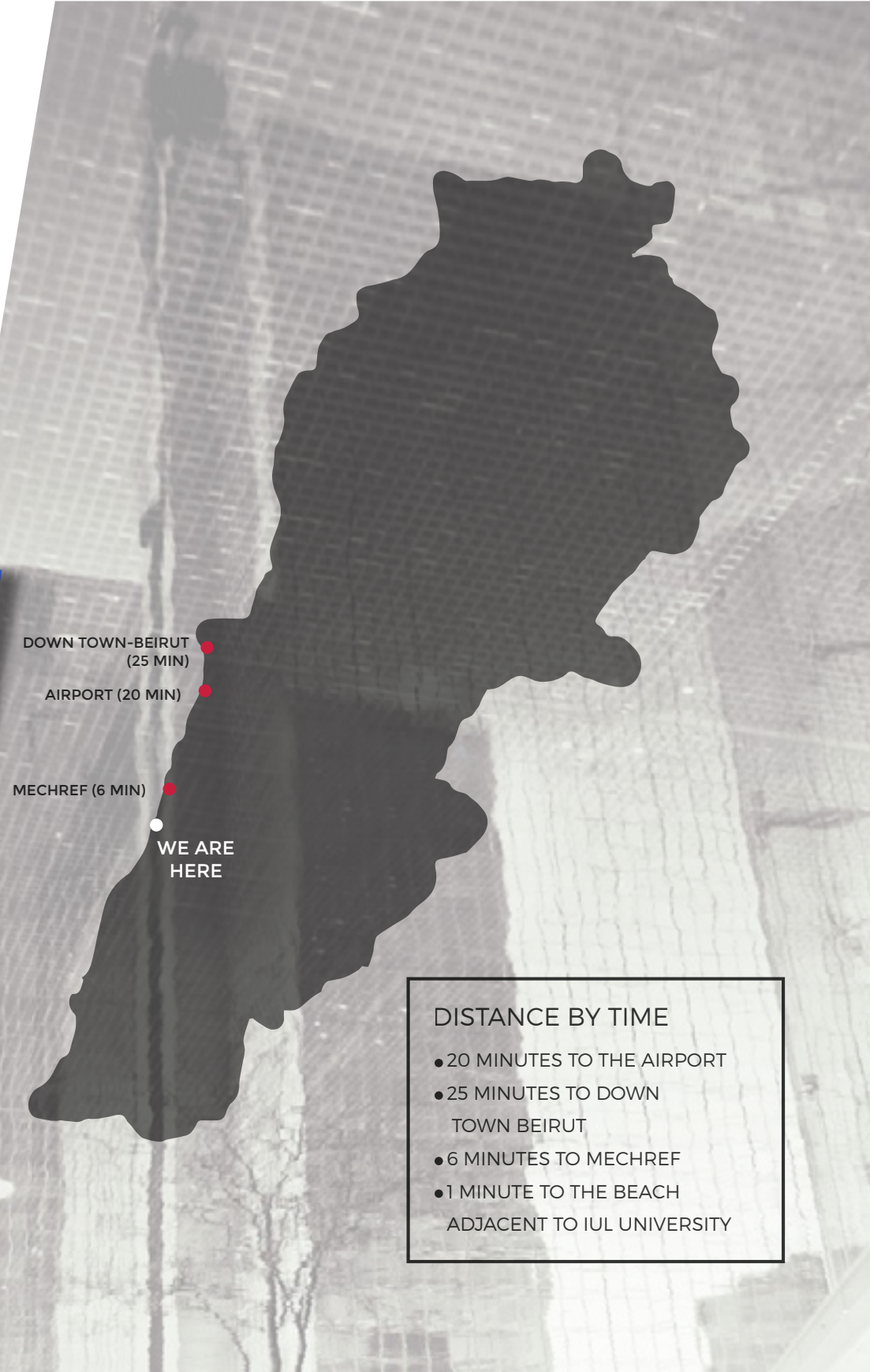
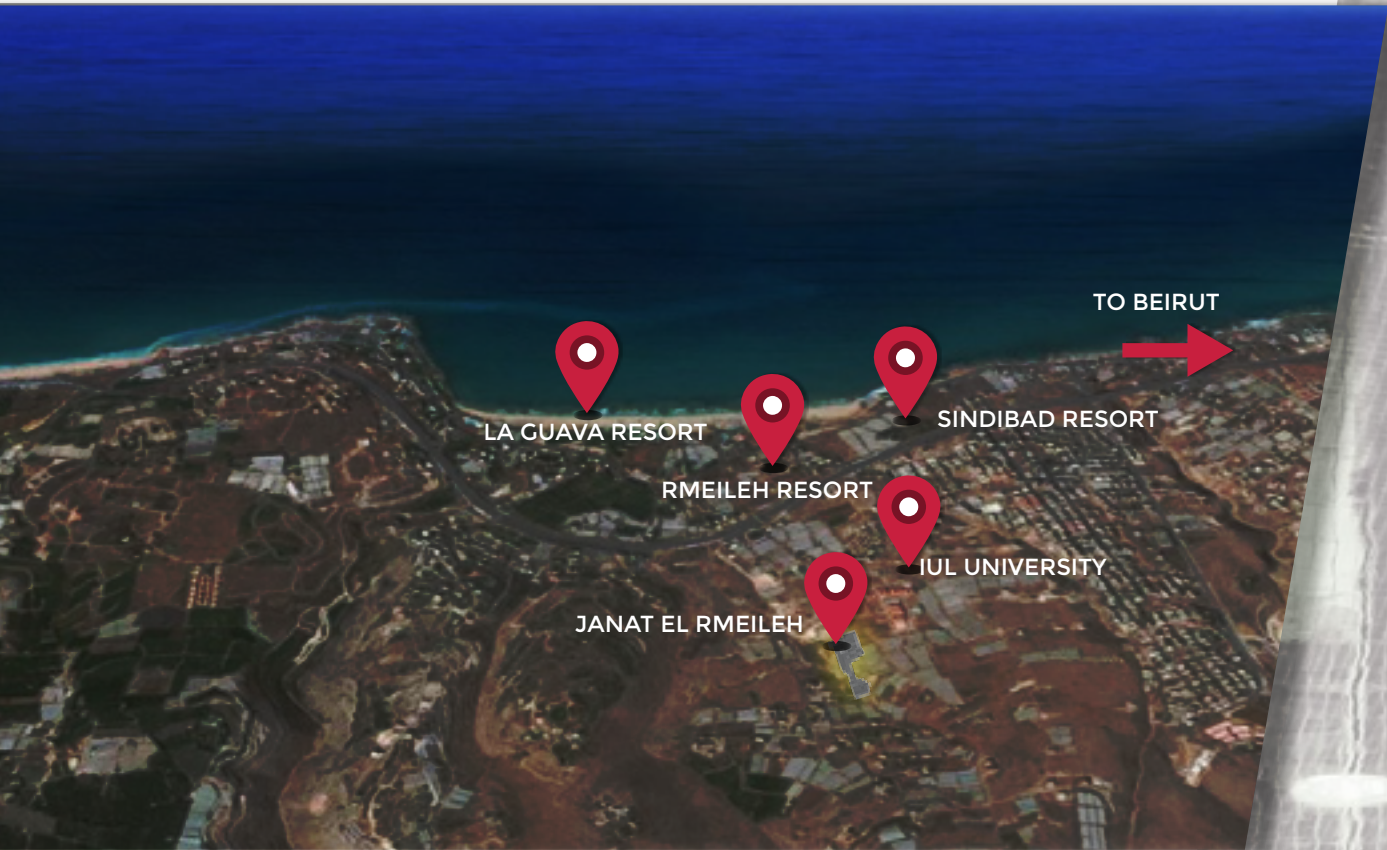

- DISTANCE BY TIME
- 20 MINUTES TO THE AIRPORT
  - 25 MINUTES TO DOWN TOWN BEIRUT
  - 6 MINUTES TO MECHREF
  - 1 MINUTE TO THE BEACH ADJACENT TO IUL UNIVERSITY



*Seconds away from the highway-  
yet calm and peaceful*



## NATURAL CHARM //

Stunning scenery, crystal clear water and a serene atmosphere, Rmeileh has become a very desirable area in the past recent years, arguably the most desirable district on the lebanese coast.





## JANAT LÜBNAN //

Is a village that **stands out**, offering a differentiated lifestyle, situated on the top of a hill adjacent to an educational university, minutes away from a number of touristic establishments, beach resorts and hotels.

DIFFERENTIATED  
**LIFESTYLE**





I'M ON TOP OF  
**THE WORLD**

## STUNNING SCENERY //

The villas command **breathhtaking** views of the mediterranean to the west and the city to the south.





## LUXURIOUS LIFE STYLE //

It allows you to live in the villa of your choice in a first class project with first **class finishing**, the villas mix has been developed , offering areas ranging from 240 to 380 m2 of living space.

this is your  
space



LUXURY  
STYLE



## MASTER PLANNING //

An ideal location, the town of Rmeileh, a place where you can find **security, relaxation and dreams**. Rmeileh the pearl of the Lebanese coast. Consisting of 75 prestigious residential villas varying in areas, each villa is accessed by its own spacious vestibule featuring its own space and parking.

THE SKIES  
ARE NOT OUR LIMIT





SAFEST ENVIRONMENT  
**FOR YOUR FAMILY**



**OUTDOOR SPACE //**

The villas are **wide, open and spaced out** with plenty of greenery and manicured parks. Surrounded with beauty ...



## INNER PEACE //

All within its own **private secure** community, offering a high level of privacy which in fact lacks in many of the villas presented in today's market.



### Ground Floor

Salon  
Gym  
Kitchenette  
Main Lobby  
Maid Room  
WC  
2 Car Parkings  
Swimming Pool  
Garden  
Surface: 130m2





**First Floor**  
 Salon  
 Dining  
 Main Lobby  
 Kitchen  
 GuestWC  
 Garden  
 Surface: 130m2



**Second Floor**  
 2 Bedrooms  
 Master Bedroom  
 2 WC  
 Fitting Room  
 Main Lobby  
 Surface: 130m2





when classy  
meets friendly

WARM ENVIRONMENT //

Enjoy ever changing scenery with the four seasons  
passing by a symphony of **biodiversity** and play.  
from every space enjoy truly unique outdoors.



## ATTENTION TO DETAIL //

Built with **tasteful finishing**, great attention to detail at every turn. . . Welcome to your amazing stylish comfortable home.

COZY AMBIENCE  
YET EDGY

ROYAL  
YET HUMBLE





PERCETION  
exists

YOUR HOME  
IS HERE



# SPECIFICATIONS //

## GENERAL FEATURES OF THE PROJECT

- A Resort-Style project
- A toned-to-perfection fitness Gym
- Swimming Pools
- A restaurant and cafes
- Beautifully Landscaped Environs
- Lush Green Manicured Gardens
- Wide paved walkways with trees
- Water Bodies and Green Parks.
- Drive-in Parking Spaces
- A 24/7 security guard agency

## TECHNICAL VILLA’S SPECIFICATIONS

- Exterior Stone cladding on Exposed facades as indicated by Architect
- High class quality Italian or Spanish Grace floor tiles in the living room and the balconies
- Italian or Spanish Grace floor tiles in the bedrooms and hallway
- Bathrooms and kitchens tiled with high quality European ceramics or porcelain.
- Fitted lacquered kitchen with granite worktop
- Walls are colored with high quality paint
- Bath rooms fittings European with 5 years warranty
- European PPR for embedded pipes inside the apartments with a 50 years warranty
- NTG water tanks with a 10 years warranty
- External walls : Double masonry walls to provide best thermal protection
- Roof and terraces protected by water proofing membranes
- Wires and cables: Liban Cables.
- The entrance door are made of wood.
- Interior lacquered doors MDF
- Windows are made of aluminum sidem 2000 original

## STRUCTURAL SPECIFICATIONS

- Capacity of the structural resisting elements will be determined in accordance to, the Uniform Building Code “UBC 97” and “ACI 11-318”. The buildings will be studied to be subjected to lateral loads due to Seismic forces corresponding to zone (Seismic Zone factor, Z=0.25) Concrete Compressive Strength: 30 Mpa and 35 Mpa for structural R.C. elements.
- Yield Strength of tied rebar reinforcing steel: 460 MP

# OUR WORDS //

The Project is shaping the towns future through its unique architecture, within the design lies the essence of its achievement to harness the elements of nature to fulfil the contemporary desires of residence, the unique attractiveness of the project is complemented by the work of internationally renowned architecture company “SCRAPERS”, who tasty contributed to the design of the project and choice of materials.

**RightTouchEngineeringGroup**, is a name synonymous with excellence and dependability we don’t build properties, we create homes. With the development of Janat El’Rmeileh, we now pass another milestone in our progress. We knew what you needed, so we are assigning the right team, to accomplish your desired requirements in the right way, delivering the projects on the right time, or simply providing the, **Right Touch....**

We simply  
provide the  
*Right Touch*



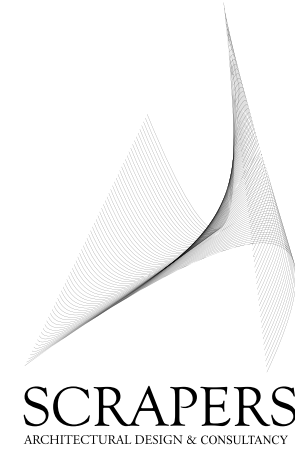

Scrapers is a Full Service Architectural company dedicated to the concept that architecture is a socially responsible and environmentally respectful pursuit. We are committed to making outstanding designs, integrate all of our services to create projects that meet clients' needs both now and in the future.

We put all our talents, ideas and experiences toward striking the right balance between achieving unequalled building solutions and meeting our clients' ultimate visions.

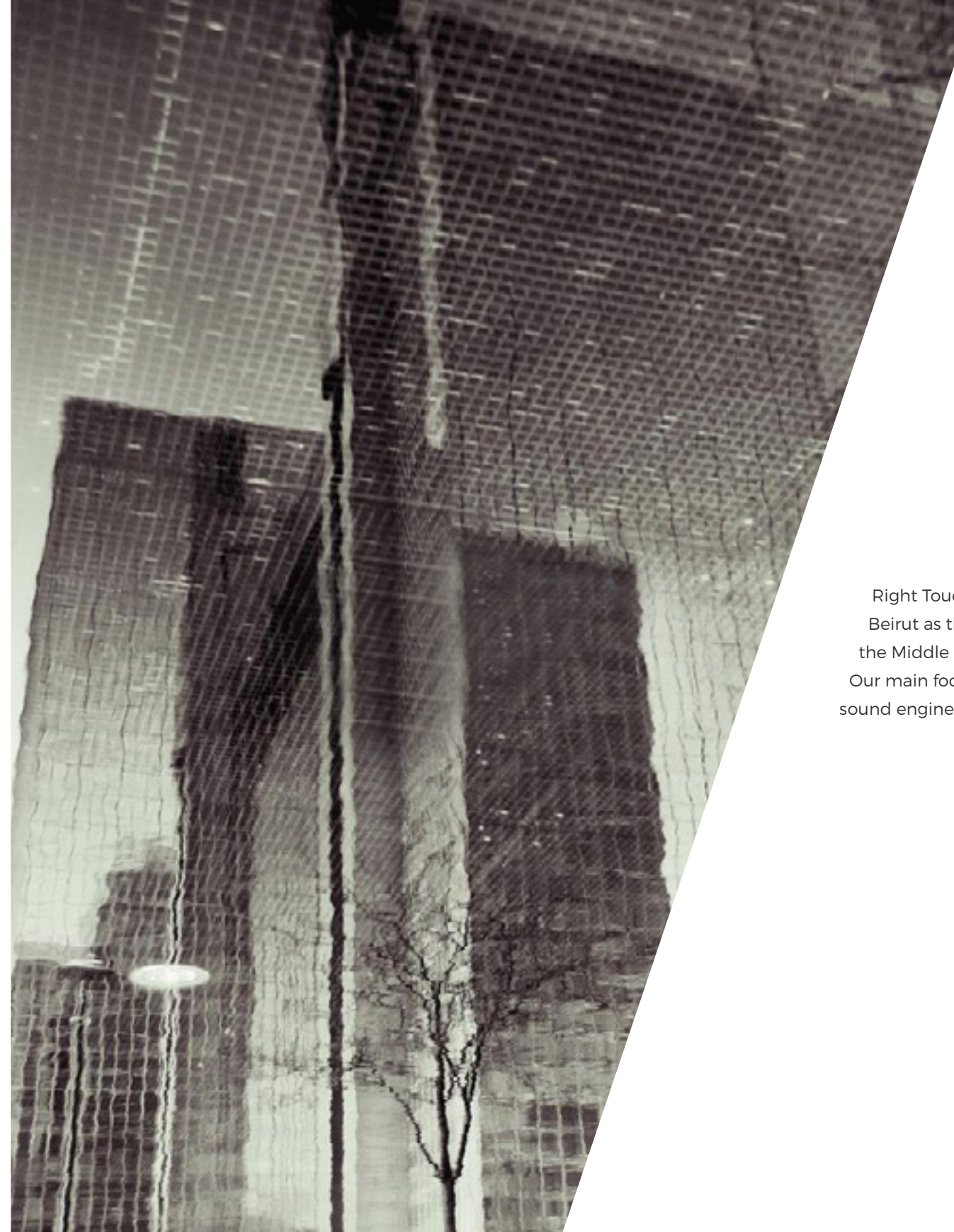

Right Touch Engineering Group is a leading Engineering and Development company that took Beirut as the location of its headquarters, to direct and follow up its projects operations in the Middle East and Turkey.

Our main focus is to improve the quality of life and the environment through the provision of sound engineering seeking to deliver the best services to our international and local clients.

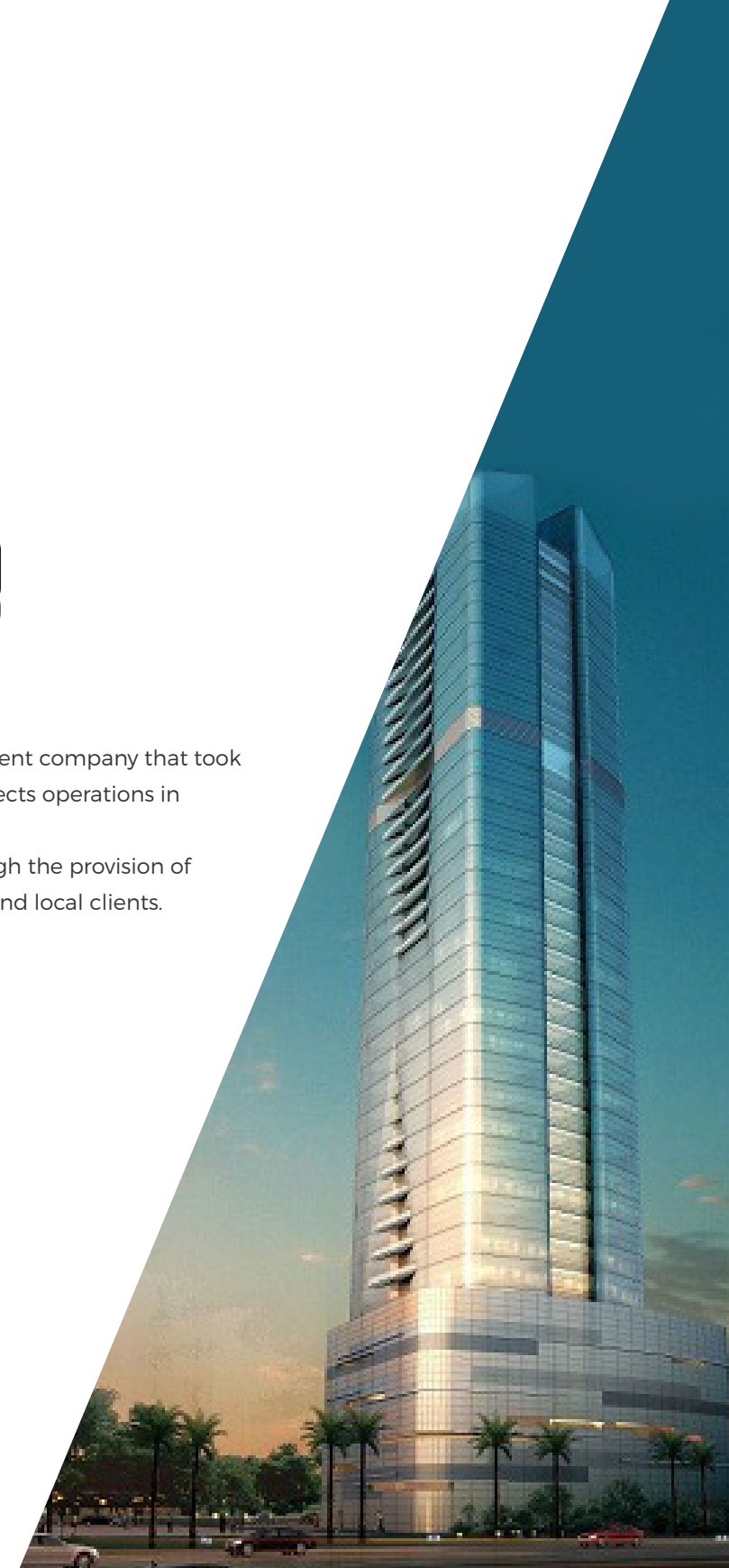





Koncord Contracting co has been around since 1976 and is today one of the most prominent infrastructure firms leading the industry with works executed covering most infrastructure works in Lebanon and Saudi Arabia

At Koncord, we've built our livelihoods and started in construction and rehabilitation works, we've then entered the infrastructure works world and experienced it all from dams to roads construction.



Park Lane Construction is specialized in the mechanical & electrical construction sector, provides complete, collaborative, end-to-end solutions, infusing life into new buildings and sustaining life in existing ones.

Park Lane construction has rapidly expanded and grown from strength to strength, delivering exceptional performance and earned a reputation as a highly dependable Specialist MEP Contractor in Beirut, having executed work on landmark towers in prime locations.





L'ART-QUI-TECTE

L'art-qui-tecte is a firm of young architects and designers motivated to make the world a better place. We can transform your vision of a perfect space and enviroment into reality through our ability to translate thoughts into concrete solutions.  
We are dedicated to craft an exceptional experience for our clients on both aspects design and creativity.





# LIST OF PARTIES //

**Owner/ Developer :**  
Jannat Development S.A.L.

**Consultants & Design office:**  
Scrapers "Architecture Design & Consultancy"  
Engineer Diana Sammak's office  
Architect Fawaz Fawaz's office

**Interior Design office:**  
L'art-qui-tecte

**Contractors:**  
Right Touch Group  
Koncord contracting co.

**MEP Contractor:**  
ParkLane Construction

**Graphic & Web Design:**  
L'art-qui-tecte  
Gcreations



[www.JannatLubnan.com](http://www.JannatLubnan.com)

**Right Touch Engineering Group** Tabara Street, Rayan Building, 1st floor, Sanaya - Lebanon  
Tel: +961 1 748820 Mob: +961 3 888020 / +961 70 975336 Email: RTEG@outlook.com

 [www.youtube.com/jannatlubnan](http://www.youtube.com/jannatlubnan)

 [www.facebook.com/jannatlubnan](http://www.facebook.com/jannatlubnan)

The contents of this brochure are intended to give a general indication of the proposed development, and are for illustrative purposes only. Accordingly, the brochure shall not be considered an element of the contracts nor be used by anyone to clarify or complete any provisions of, or omissions from, any contract of sale.

